

INTELLI-RV 500AMP SHUNT MODULE

P/No. PMSHUNT



INSTALLATION GUIDE



Please read this document very carefully to avoid battery monitor malfunction or fire hazards.

The active shunt must be located in a dry environment.

MOUNTING THE MODULE

Do not use mounting screws with countersunk heads.



WARNING:



- The shunt must always be installed into the negative line.
- The battery negative terminal may only contain one cable, which is the one going to the shunt. If there are other cables connected to this terminal as well, this may produce incorrect display readings.
- Always connect the battery negative terminal to the 'B-' stud of the shunt. Connecting this terminal to the 'S-' stud will produce incorrect display readings.

Always disconnect the battery negative cable first before installation.

Always connect the battery negative cable last when the installation has been completed.

More information <https://www.caravansplus.com.au>

INSTRUCTIONS

- Battery temperature sensor is optional and should be attached to the service battery (B1)
- Assembly sequence of nut, washers and cable lug:

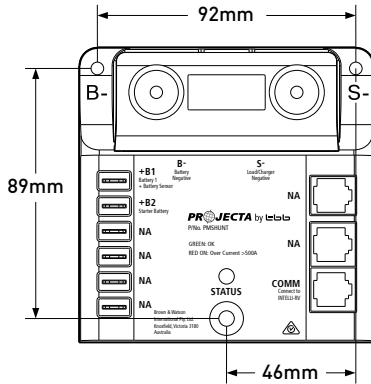
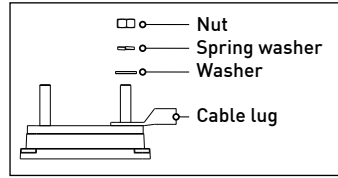

STATUS LED

GREEN: OK

Red ON: Over current >500Amp

CONNECTION DIAGRAM FOR SINGLE BATTERY SETUP

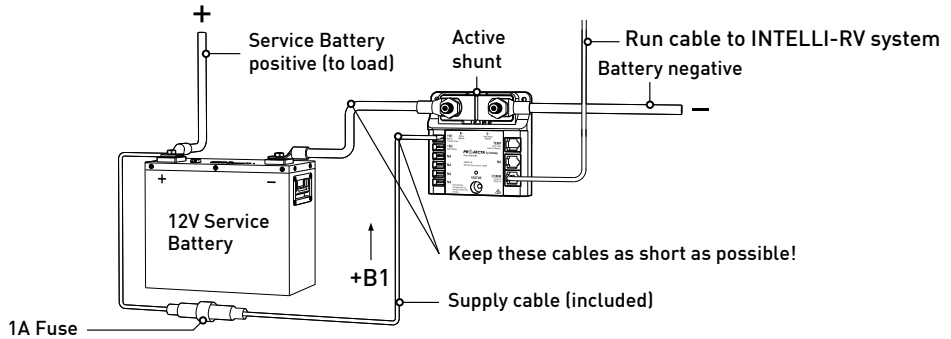

CONNECTION DIAGRAM FOR DUAL BATTERY SETUP

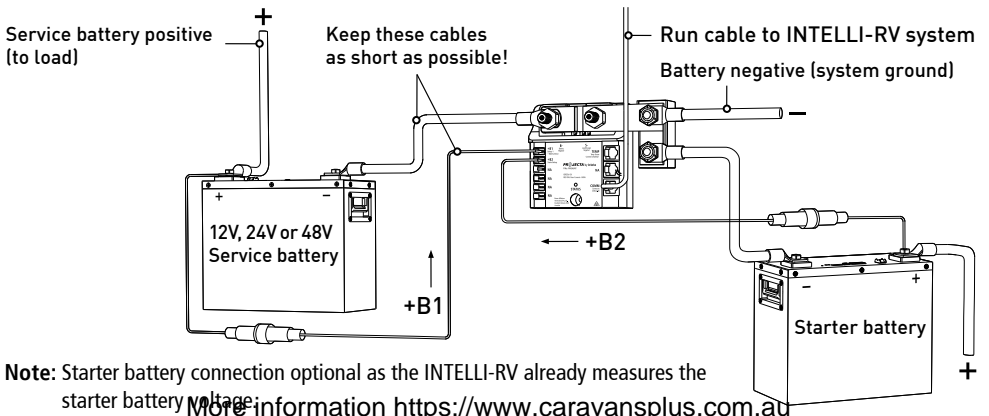

Note: Starter battery connection optional as the INTELLI-RV already measures the starter battery voltage.

More information <https://www.caravansplus.com.au>

SETUP VIA THE APP

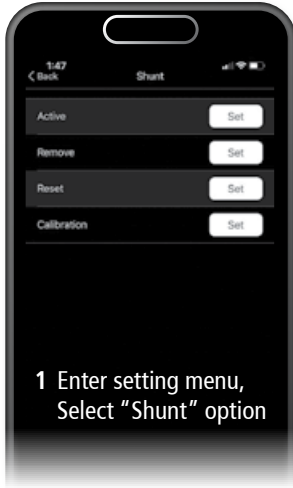

1 Enter setting menu, Select "Shunt" option

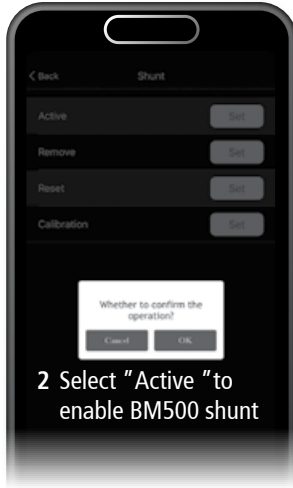

2 Select "Active" to enable BM500 shunt

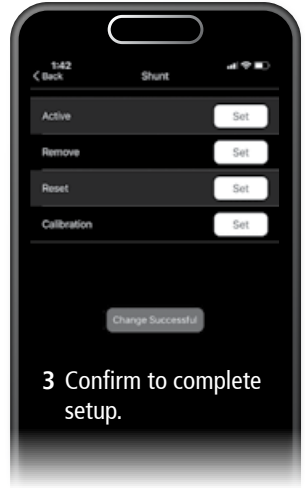

3 Confirm to complete setup.

SET UP VIA LCD

- Press the 'Light' button until the setting code is showing on the date time area which means the monitor is ready for configuration. The 'PUMP' button and 'LOAD' button can be used to scroll through the configuration menu.

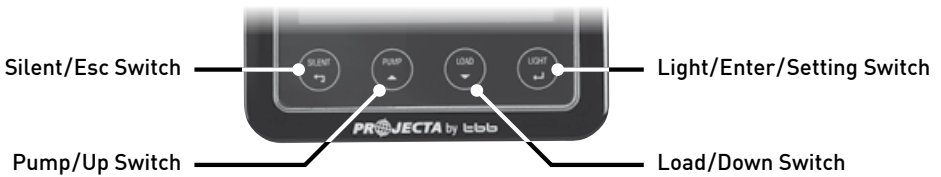

- 1 Press and hold "Pump" and "Load" buttons

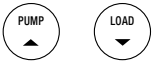

- 2 Engineering Screen displays



- 3 Press and hold "Light" button



- 4 Press "Load" button to scroll to "Module"

Module

- 5 Press "Light" to select

- 6 Press "Load" to scroll to "BM"

BM

- 7 Press "Light" to select

- 8 Press "Load" to scroll to "01"

01

- 9 Press "Light" to select

- 10 Press "Silent" until you return to Engineering Screen



- 11 Press and hold "Pump" and "Load" buttons to exit engineering mode

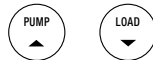

- 12 Shunt set up complete

More information <https://www.caravansplus.com.au>

PM300 + PMSHUNT WIRING DIAGRAM

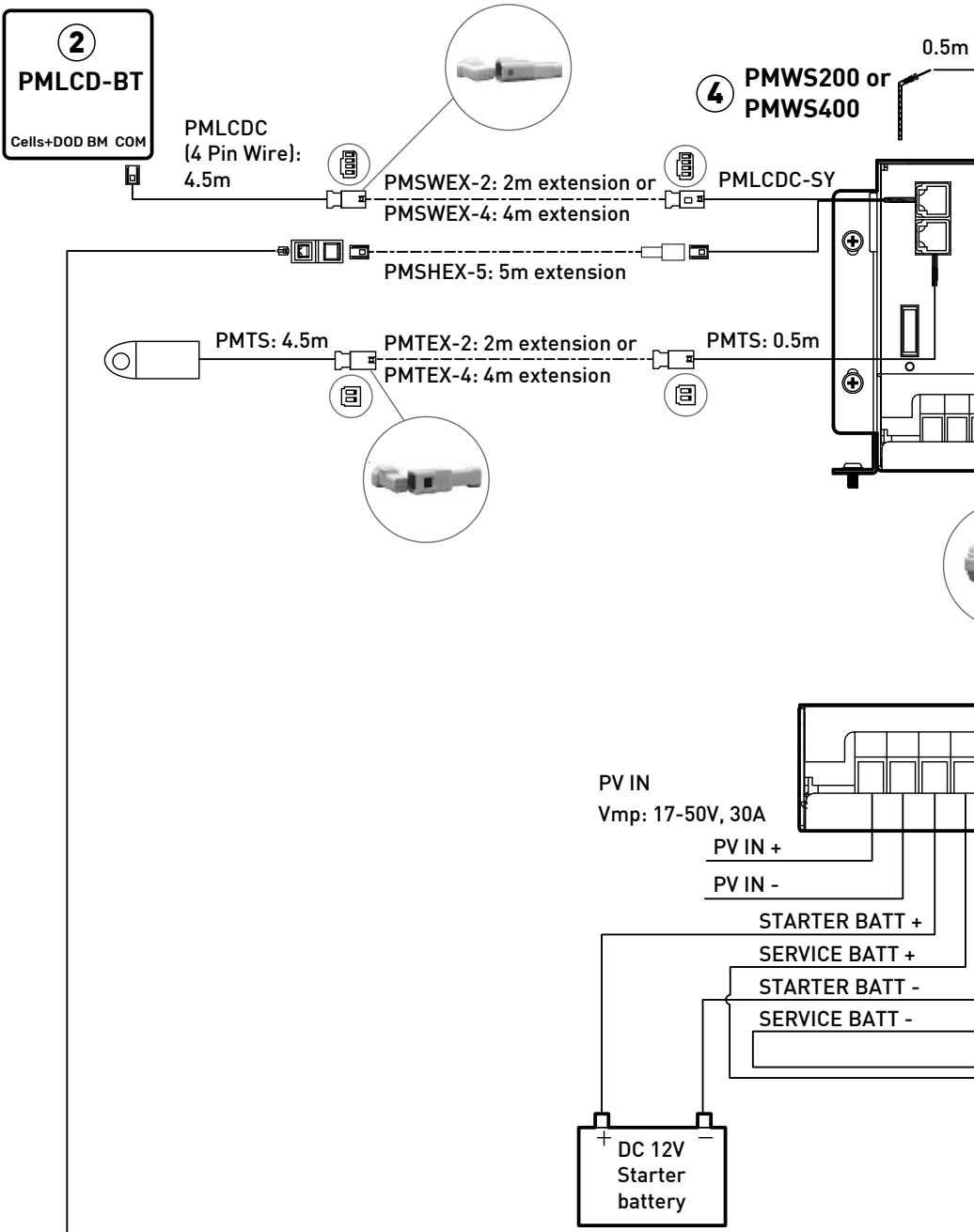

More information <https://www.caravansplus.com.au>

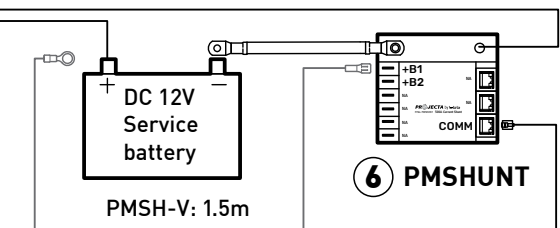
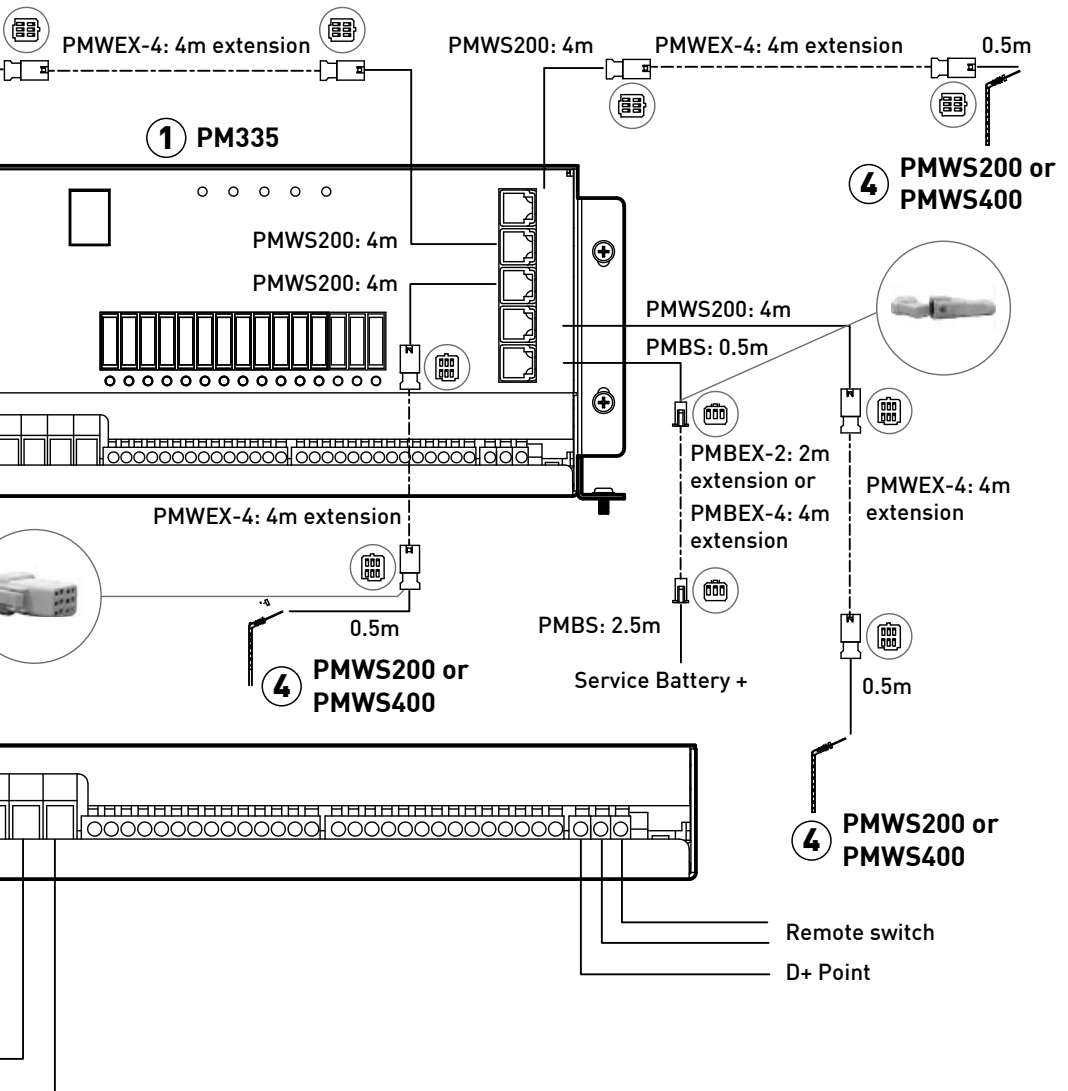

More information <https://www.caravansplus.com.au>

PM400 + PMSHUNT WIRING DIAGRAM

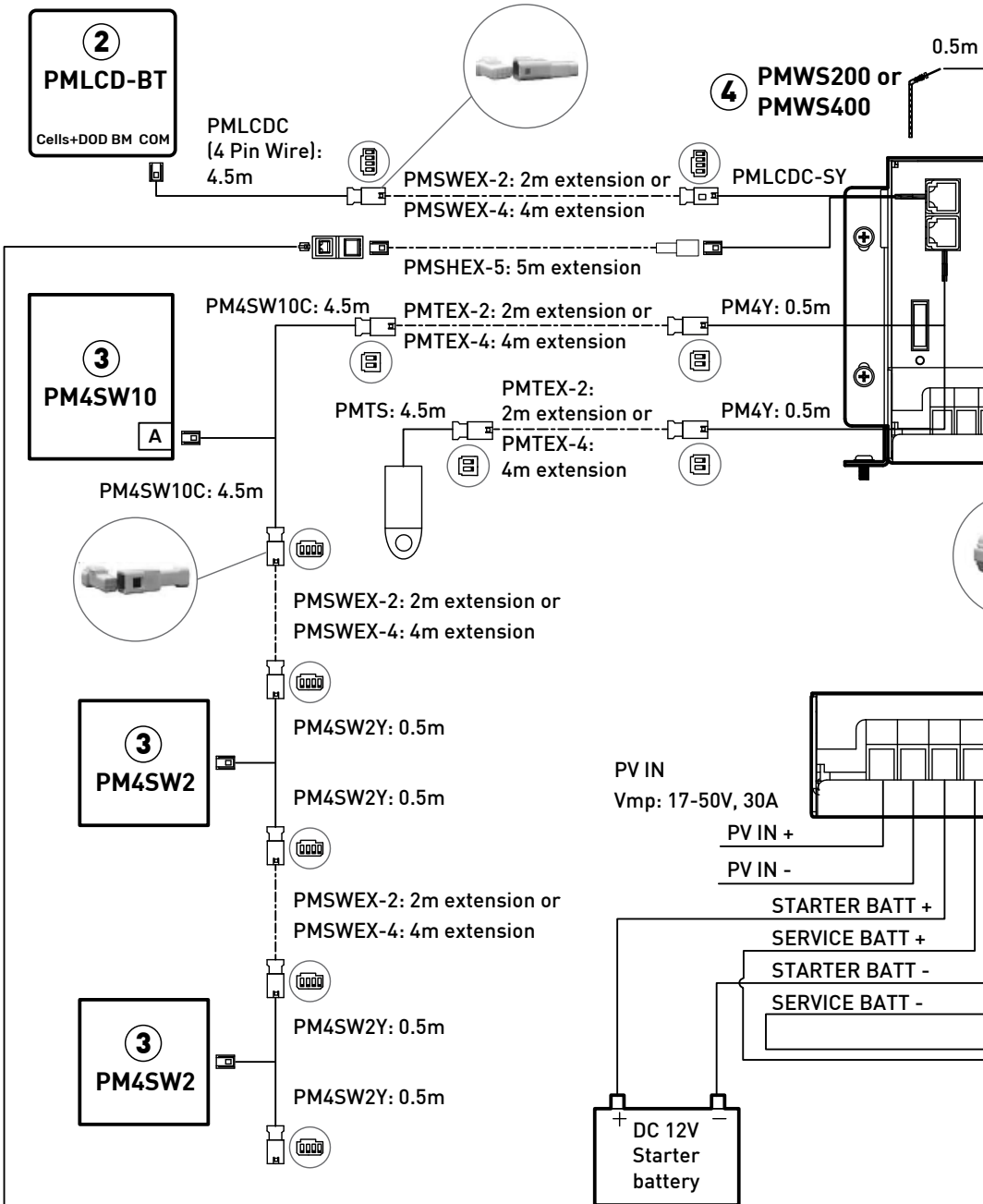

More information <https://www.caravansplus.com.au>

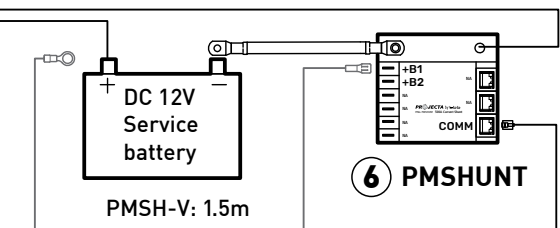
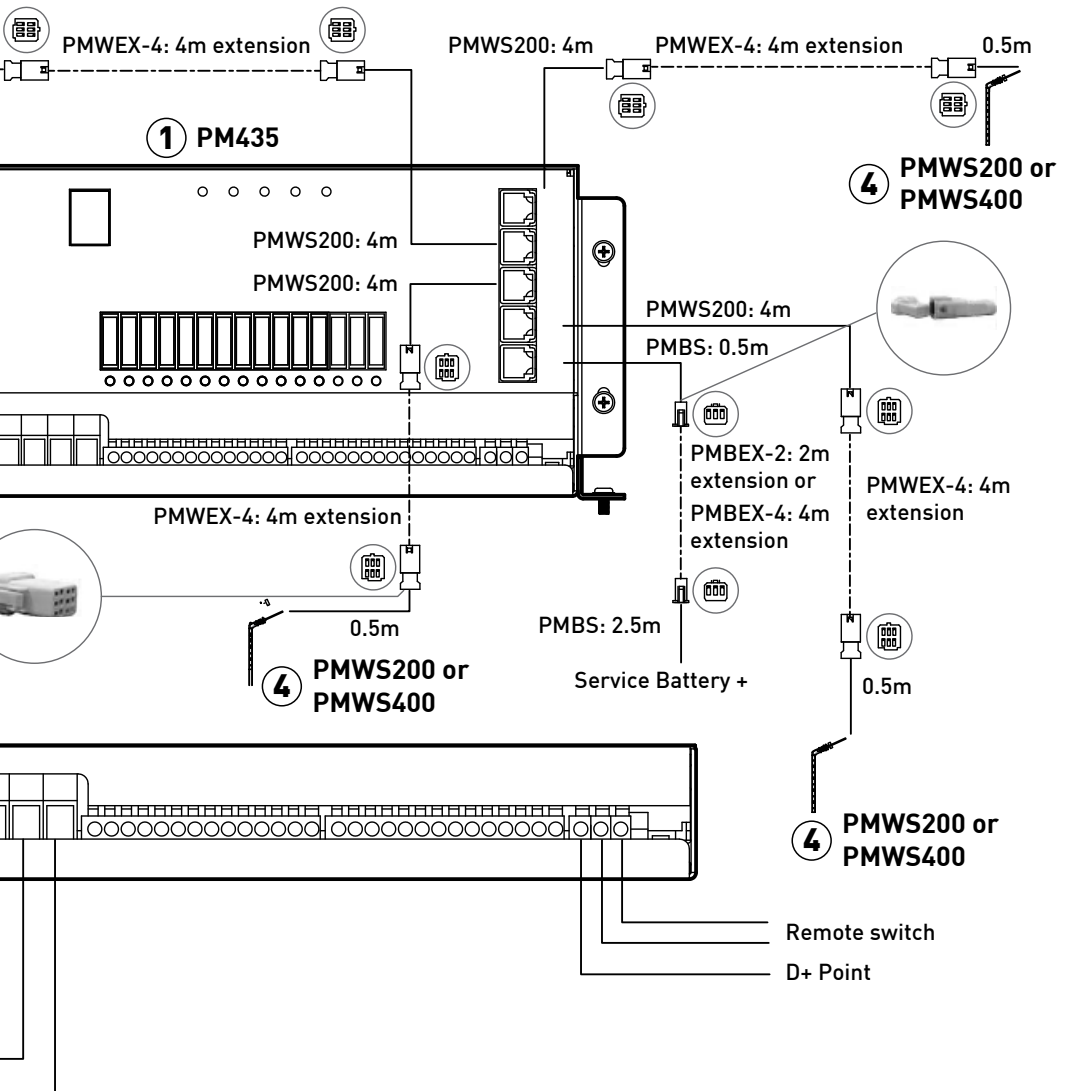

More information <https://www.caravansplus.com.au>

WARRANTY STATEMENT

Applicable only to product sold in Australia

Brown & Watson International Pty Ltd of 1500 Ferntree Gully Road, Knoxfield, Vic., telephone (03) 9730 6000, fax (03) 9730 6050, warrants that all products described in its current catalogue (save and except for all bulbs and lenses whether made of glass or some other substance) will under normal use and service be free of failures in material and workmanship for a period of two (2) years (unless this period has been extended as indicated elsewhere) from the date of the original purchase by the consumer as marked on the invoice. This warranty does not cover ordinary wear and tear, abuse, alteration of products or damage caused by the consumer.

To make a warranty claim the consumer must deliver the product at their cost to the original place of purchase or to any other place which may be nominated by either BWI or the retailer from where the product was bought in order that a warranty assessment may be performed. The consumer must also deliver the original invoice evidencing the date and place of purchase together with an explanation in writing as to the nature of the claim.

In the event that the claim is determined to be for a minor failure of the product then BWI reserves the right to repair or replace it at its discretion. In the event that a major failure is determined the consumer will be entitled to a replacement or a refund as well as compensation for any other reasonably foreseeable loss or damage. This warranty is in addition to any other rights or remedies that the consumer may have under State or Federal legislation.

IMPORTANT NOTE

Our goods come with guarantees that cannot be excluded under the Australian Consumer Law. You are entitled to a replacement or refund for a major failure and compensation for any other reasonably foreseeable loss or damage. You are also entitled to have the goods repaired or replaced if the goods fail to be of acceptable quality and the failure does not amount to a major failure.

Distributed by

AUSTRALIA

Brown & Watson International Pty Ltd

Knoxfield, Victoria 3180

Telephone (03) 9730 6000

Facsimile (03) 9730 6050

National Toll Free 1800 113 443

NEW ZEALAND

Narva New Zealand Ltd

19 Bell Avenue,

Mount Wellington,

Auckland 1060, New Zealand

Telephone (09) 525 4575

Facsimile (09) 579 1192

More information <https://www.caravansplus.com.au>