



# **FITTING INSTRUCTIONS FOR CAMEC SLIMLINE SLIDER WINDOW**

**Rev. 3 - 04-2011**

Using these Instructions along with the correct Clamp Ring, to suit the wall thickness, the completed Installation should be able to be carried out quickly and accurately.

1. All cut-outs to be 6 mm +/- 1 mm larger than nominal sizes on ALL windows.
2. Cut-outs to be square and parallel within 1-2 mm.
3. Make sure outside wall surface is clean.  
Aluminium cladded walls require seams filled with silicone and crushed.

For example: Standard Fitting of Clamp Ring:  
565 x 1175 Camec 4RC Side Sliding Window requires a cut-out size of 570 to 572 High x 1180 to 1182 Wide, with 68 mm radiuses cut in each corner.

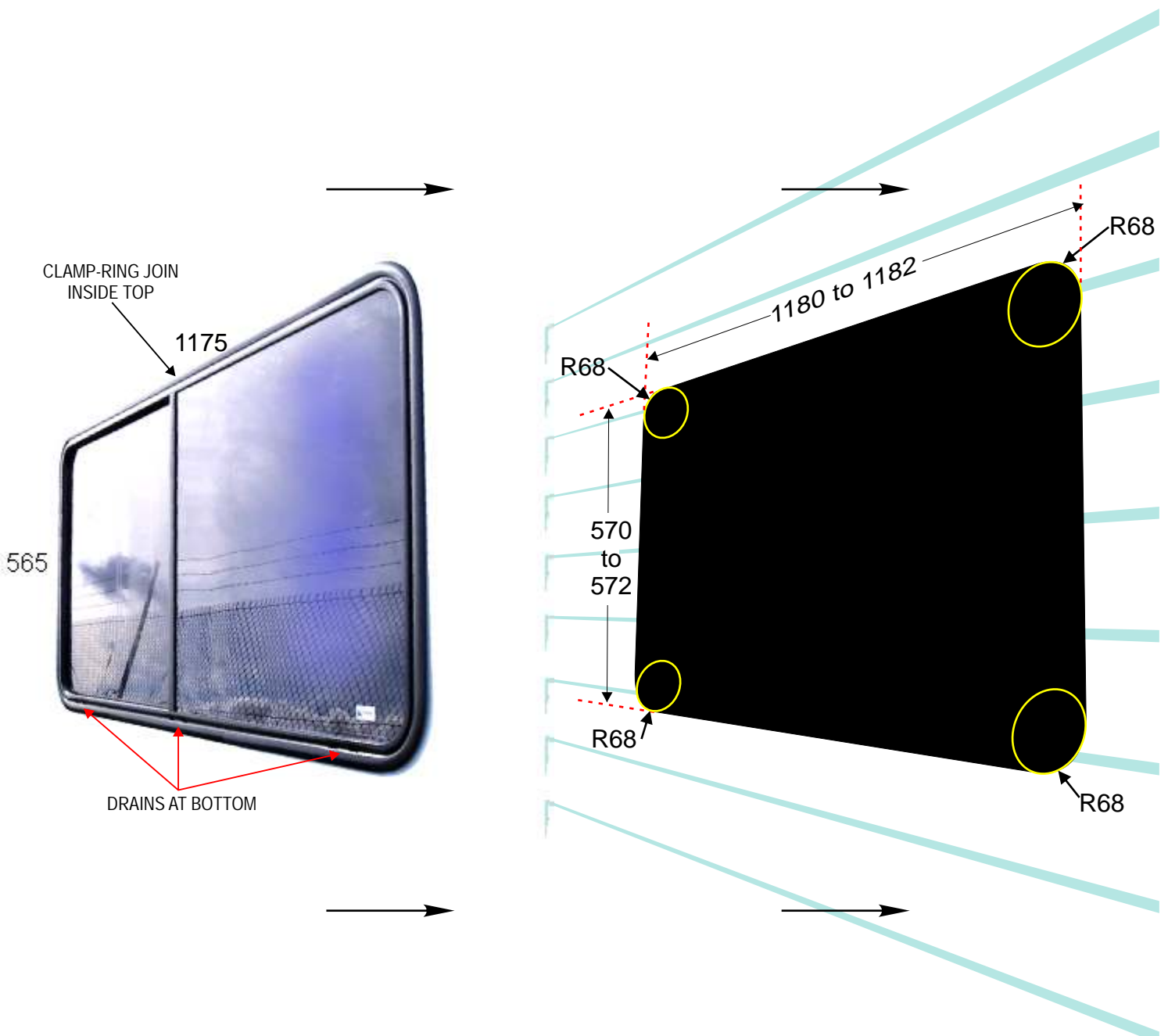

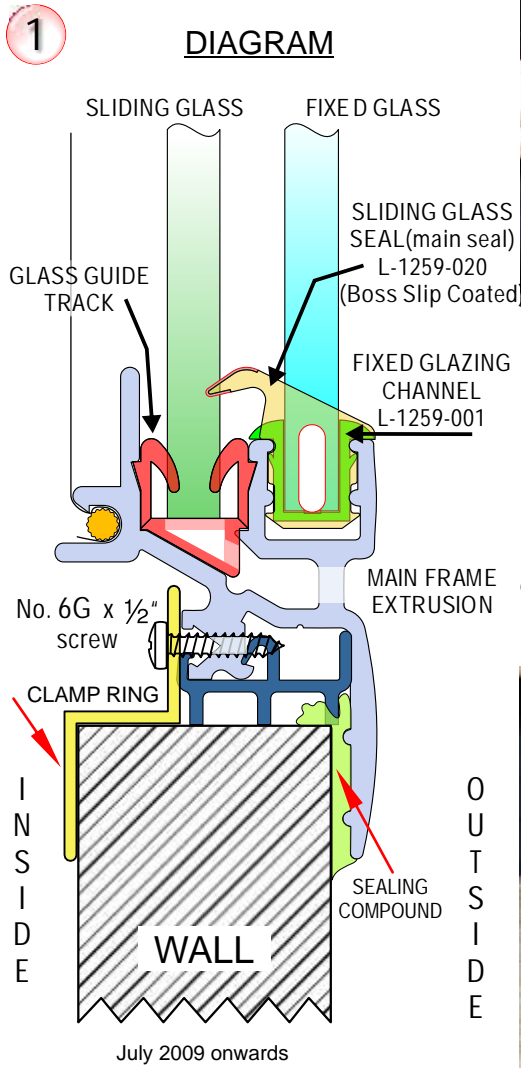

Cross section of lower part of window and wall

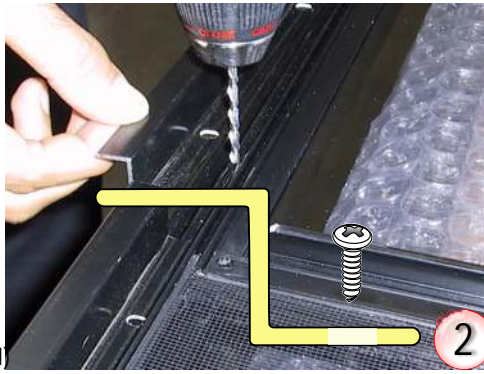

With clamp ring over window and join at the top of the window, use a 2.5mm drill bit and drill a hole on both sides of the clamp ring join and temporary install 2 anchor screws.  
Use 6G PAN Phillips self tapping screws with a maximum length of 1/2"

*Take Care!* Only drill through the first section of the extrusion. Do NOT drill completely through.



Anchor clamping at the bottom of the window in the same manner by drilling mainframe and anchoring with 2 screws.



Drill the rest of the holes into the mainframe.



Remove temporary anchoring screws.



Clean window of aluminium swarf by blowing away with compressed air.



Clean dust and dirt from around the opening where the window is going to be fitted. Wipe window main frame flange with a dry cloth to remove dust. Apply sealing compound to flange. Foam tape is used in this case in the above picture.



For sealing compound use:

- 1). Butyl Mastic.
- 2). Double sided or one sided foam tape.
- 3). Silicone Sealant.
- 4). A suitable combination of the above.

**DO NOT USE ADHESIVE**



Apply Sealing Compound (in this case foam tape) all the way around the flange. Mid-Bottom of the window is a suitable starting point. Take particular care around the four radius corner. Cut off tape end at the starting point to form a continuous seal. Join foam tape, cleanly, as above. Apply silicone to tape.



Position window in opening on the wall of the van where it is going to be installed. Do this from the outside of the van.



With the bottom of the window in place, gently push the top of the window in position in the opening.

**MAKE SURE WINDOW IS CENTRALISED IN CUTOUT. USE SPACERS IF NECESSARY**



One person needs to hold window from the outside of the van.



Top of window. T-Joiner cut out the same height as the clamping. Plastic T-Joiner may need to be trimmed to allow clamping to sit flat against inside wall.



Bottom of window. T-Joiner cut out the same height as the clamping.

**Take Care! Join in Clamp Ring at Top of Window**



Position clamping around the window.



Attach clamping screw either side of join.

*Note!* When using silicone bedding, do not fully tighten clamping until silicone has cured. Over tightening when silicone is fresh WILL cause leaks.



Fasten 2 bottom screws. The rest of the screws can be installed. Remove excess silicone or any other be sealing compound - general cleanup.

INSTALLATION COMPLETE



**FINISHED PRODUCT**