

Installation instructions

Installation of the unit may only be carried out by properly qualified professionals.

This unit shall be installed in accordance with the manufacturer's installation instructions and any other relevant statutory regulations.

Data Label

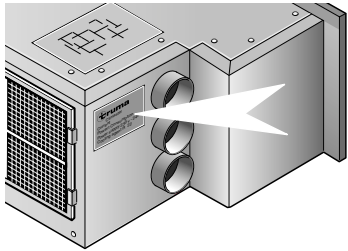

The data label is located on the side of the unit, beside the indoor air outlets.

Intended use

This device was designed for installation inside mobile homes and caravans. Any other applications are only possible after consultation with Truma.

Regulations

Any alteration to the unit, or the use of spare parts and functionally-important accessories which are not original Truma components, or failure to respect the Installation and Operating Instructions, will lead to the cancellation of the guarantee and to the exclusion of claims for liability.

Air conditioner kit

The air conditioner kit contains:

- 1 Pre-assembled air conditioner
- 16 Screws 19 x 4 mm (pointed)
- 1 Outer wall grill cover
- 11 Screws 19 x 4 mm (flat)
- 10 Plastic spacers
- 1 Tensioning belt
- 2 Securing brackets
- 1 Wall switch with 3 m cable
- 1 Return air filter
- 1 Installation template
- 1 Set literature

1 Choice of location

Always install the unit in such a way that it is easily accessible for service work at all times and can be easily removed and installed.

Note: In order to achieve uniform cooling/heating of the vehicle, the air-conditioning unit must be installed **centrally** in a storage box or similar mounting in such a way that the air distribution ducts can be laid vertically in covered areas (e.g. in clothes cupboards).

The air-conditioning unit is mounted on the floor. The indoor air which is to be cooled/heated is drawn in directly by the unit via an additional air grille in the storage box wall (special accessory part no. 40040-29200) or via other apertures with a total surface area of at least 300 cm².

Caution: The indoor air will be purified and dried while the unit is in operation. Accordingly, if the unit is installed in external storage containers (e.g. double floors) suitable steps must be taken to ensure that the air which is to be cooled/heated is extracted from the interior of the vehicle. The intake of indoor air from the outside can severely impair the effect of the air-conditioning system.

2 Template

Take the template provided and separate it on the dotted line (C) to two templates.

3 Inside the caravan

1. Temporarily tape the wall aperture template inside the storage compartment in which the unit is intended to install and check the spatial conditions for the wall aperture.

 The apertures in the vehicle must be freely accessible and must not be covered by any frame elements or similar objects located behind them. **Structural sections within the walls of the caravan should be avoided for safety reasons.**

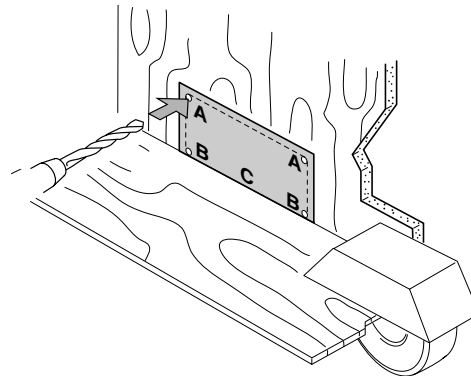

2. After checking the spatial conditions, align the aperture template as shown and fix in position with adhesive tape.

Important Note: Ensure that the bottom line (C) is on the floor!

3. Drill 2 holes (A) with 10 mm dia. through the wall. Ensure that the drill is kept square to the wall.

4 Outside the caravan

The 2 holes drilled through the wall will allow the template to be positioned correctly on the outside wall.

1. Align the position of the template with the 2 holes drilled and tape to the outside wall. Ensure that the template is square to the caravan body.

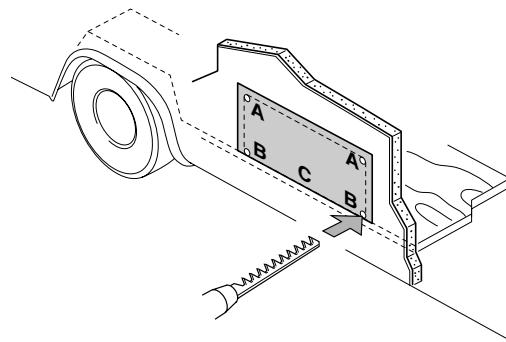

2. Drill 2 holes (B) and check that the bottom line (C) is level with the caravan floor.

3. Using a jigsaw or padsaw cut to the lines shown on the template. Remove the template

4. The hole in the caravan wall must be lined with timber to give a firm support for holding the unit in position.

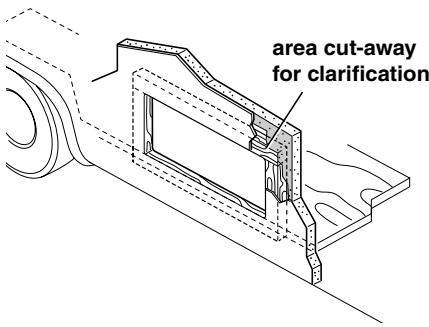

Use a non hardening mastic to seal the the lining to the inner and outer walls - do not use silicone! Secure the inner walls to the lining with panel pins.

The finished hole should be 275 mm high and 660 mm wide.

5 Fitting the air conditioning unit

1. Take the second template and place inside the vehicle in such a way that **outer line (C) is level with the outer wall** and mark the points (E) for the securing brackets.

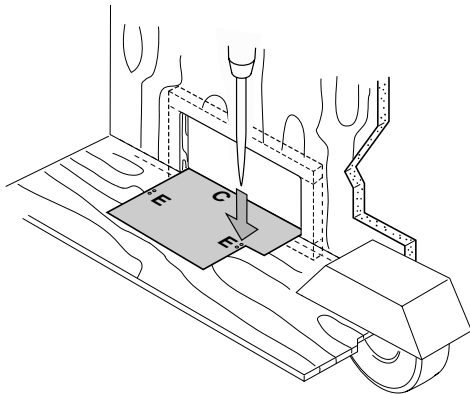

2. Remove the template. Position the tensioning belt (1) and secure to the vehicle floor with the two securing brackets (2), using two screws (3) each.

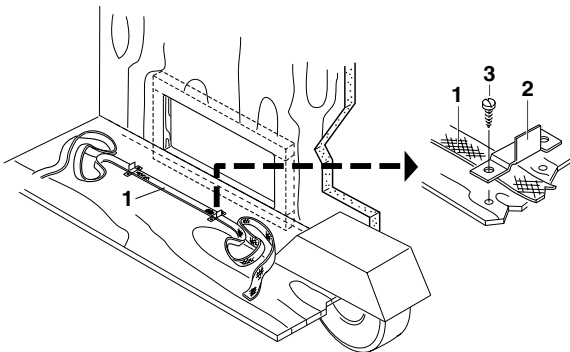

3. Offer the air conditioning unit through the hole in the wall, making sure that the 240 V cable is not trapped under the unit.

Important note: To avoid damages, only hold the unit by the outer frame. Do not push against the inner part of the unit!

4. Beginning from the centre, secure the unit with the 12 screws provided.

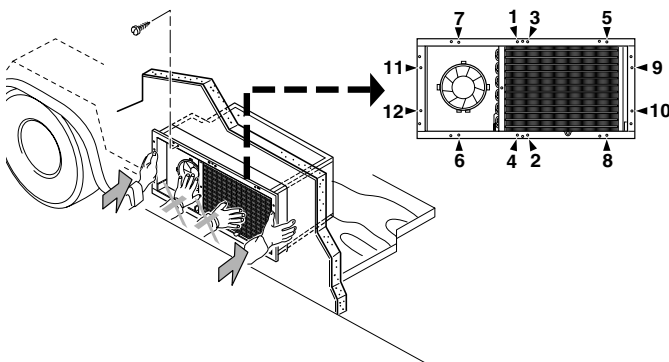

5. Position the outer grille and beginning from the centre secure with 11 screws provided. Use the provided plastic spacers on the outer screws.

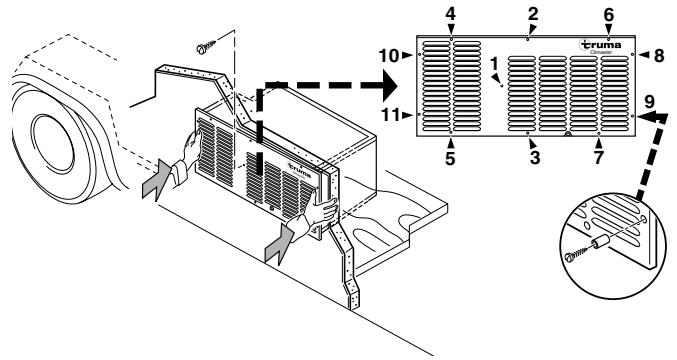

! The condensation water drain is located on the side of the vehicle. In order for the condensation water to drain away freely, after the installation a check should be made to ensure that the drain hose is free of dirt, vegetation residue, or similar obstructions. **If this is not done, there is a risk of condensation water penetrating into the vehicle.**

6. Secure the air conditioning unit with the tensioning belt (1) as illustrated.

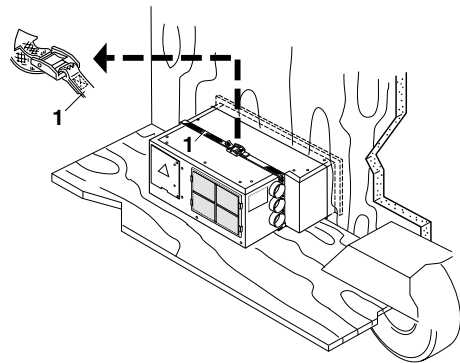

6 Installation of the control panel

1. Choose a suitable location for the control panel in the vicinity of the unit (cable length 3 m).

If required, a cable extension of 5 m can be supplied (refer to page 8).

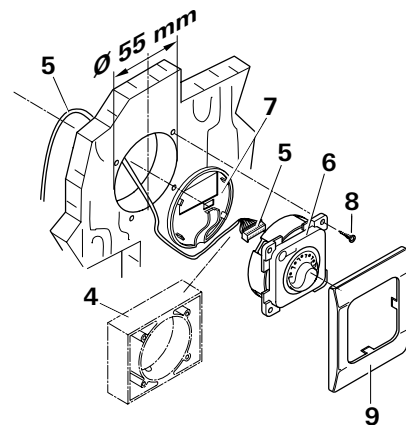

Note: If a flush installation of the control panels is not possible, use the surface mounting frames (4) supplied.

2. Drill a hole 55 mm dia. Plug the cable (5) to the control panel (6) and then fit the rear cover cap (7) as a stress-relieving device.

3. Pass the cable through the hole, lay the cable to the air conditioning unit and plug it into the side connector. Secure the control panel (6) with 4 screws (8) and fit the cover frame (9).

7 Indoor air outflow and return

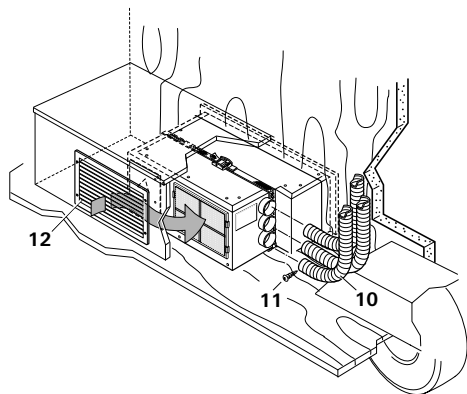

Indoor air outflow

This unit was designed for the use of KR 65 cold air ducts (10), dia. 65 mm. The ducts must be secured to the device with screws (11).

The cold air duct must be connected to all three apertures, with at least one outlet.

Important note: The cold air distribution is designed for each vehicle type individually, on the modular principle. A wide range of accessories is available (see page 8).

To achieve the best possible performance, we recommend that:

1. The air outlets be fitted in the upper part of the vehicle (see installation example on page 1).
2. A maximum of 15 m cold air ducting to be used.
3. Lay the ducts as short as possible and in a straight line to the air outlets.
4. To avoid condensation water, do not lay the ducts in the vicinity of sources of heat (e.g. behind refrigerators).

Indoor air return

The indoor air is sucked in again by the unit, either through an additional grille (12 - special accessory part), for example in the wall of the stowage compartment or via a number of smaller apertures.

The unobstructed return air opening must not be less than a minimum of 300 cm².

8 Electrical connection 230/240 V

⚠ The electrical connection is only to be carried out by a licensed electrician. The information given here is not intended as information for the layman, rather it is to assist the assigned electrician, as additional information, when connecting the appliance!

Establish the connection to the mains with the connection cable, 150 cm long, to a lead in the vehicle, fused to at least 10 A.

Always pay attention to connect carefully with the correct colours!

For maintenance and repair work a disconnecting device must be provided on the vehicle for all-pole disconnection from the power supply, with at least 3 mm contact clearance.

9 Function check

After installation, check all functions of the unit as specified in the operating instructions.

The operating instructions and the completed warranty card are to be handed over to the vehicle owner.



Hot Water Service L.P. Gas and 240 Volt

The Truma-Boiler is Europe's number one hot water service. The unique L.P. Gas and 240 V electric storage water heater features a 14-litre stainless steel tank (no more anode replacement) with a feather weight of just 7.3 kg. Of compact dimension, the Truma is just 320 mm x 350 mm x 350 mm deep, and using 92 g per hour of LPG the new unit is miserly in its consumption of gas.

The Truma features electronic ignition and controls that operate from within the van, and the user can set the temperatures to 60°C or 70°C.

The Truma unit also features a small external vent that is visually appealing, enhancing the caravan's exterior appearance.

Please ask your dealer for detailed information.

**LPG 12 Volt
Direct Spark Ignition,
240 V immersion heating
&
Stainless Steel Tank**



